

**LOCATION PLAN FOR THE G+IV RESI. BUILDING
OF SMT.MITHU PURKAIT & SMT. CHAMPA NASKAR.
AT J.L.NO.-79,KHATIAN NO. 3144 , L.R. DAG NO.40/248 ,
MOUZA - DAULATPUR, P.S. BISHNUPUR,DIST. - SOUTH 24 PGS.**

PROJECT NAME - LAKE VIEW APARTMENT

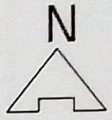

SCALE - 1:500

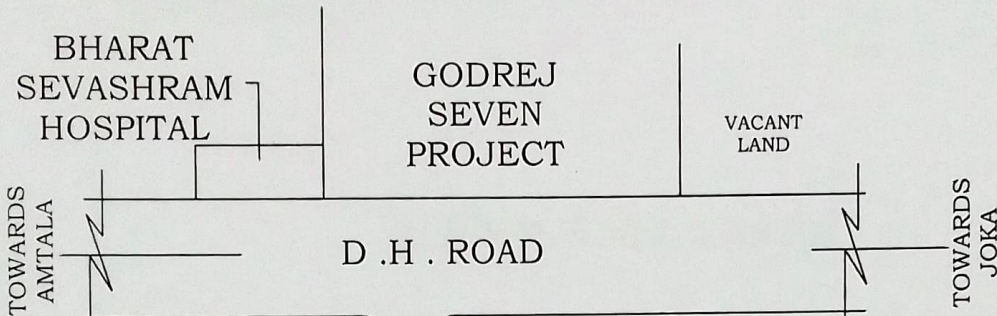

PROJECT NAME - LAKE VIEW APARTMENT

LATITUDE - 22'-43'-99"

LONGITUDE - 88'-29'-33"

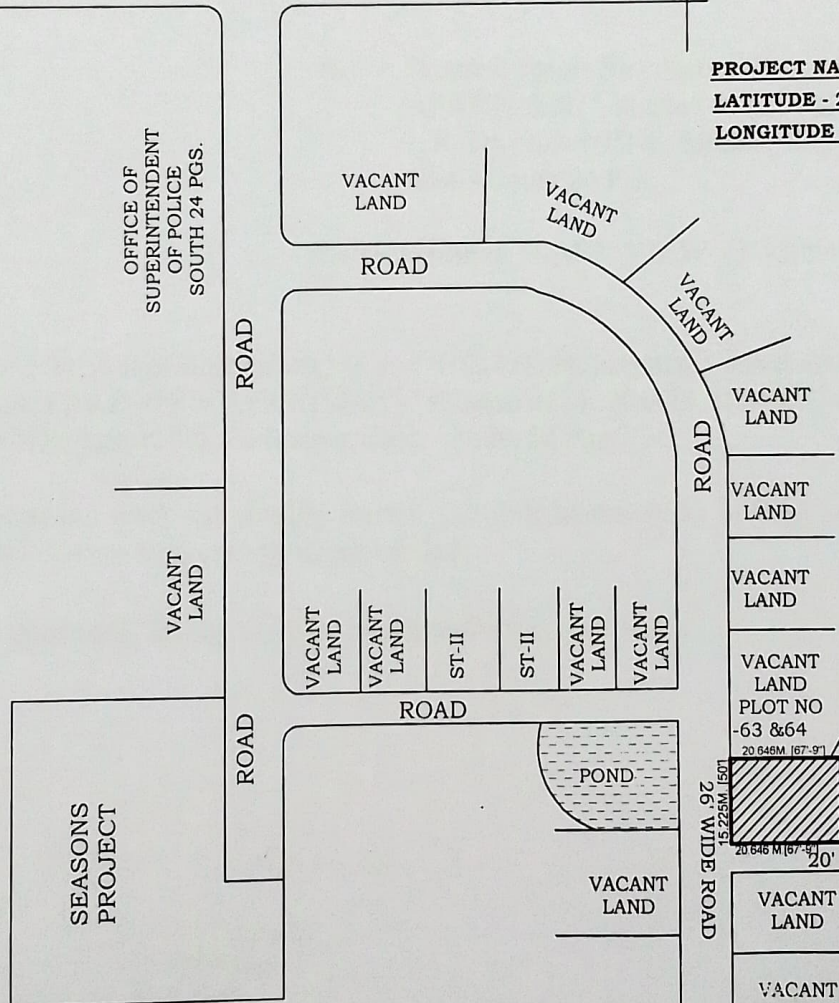

**PROPOSED SITE
(LAKE-VIEW
APARTMENT)**

J.L.NO.-79,KHATIAN NO.
3144 , L. R. KHATIAN
NO-2604,2605,2606,L.R.
DAG NO.40/248

VACANT
LAND
PLOT NO
-63 &64
20.645M [67'-9"]
10.51 M [34'-6"]
5.225M [17'-2"]
20.646 M [67'-9"]

VACANT
LAND
PLOT
NO-60
VACANT
LAND

PROJECT NAME - LAKE VIEW APARTMENT

LATITUDE - 22'-43'-99"

LONGITUDE - 88'-29'-33"

Rajrup Ghosh
Er. RAJRUP GHOSH
CIVIL ENGINEER
LBS-II/1737
(KOLKATA MUNICIPAL CORPORATION)

DRAWN BY

TOWARDS
NEPALGANJ
ROAD